

# Resort Map

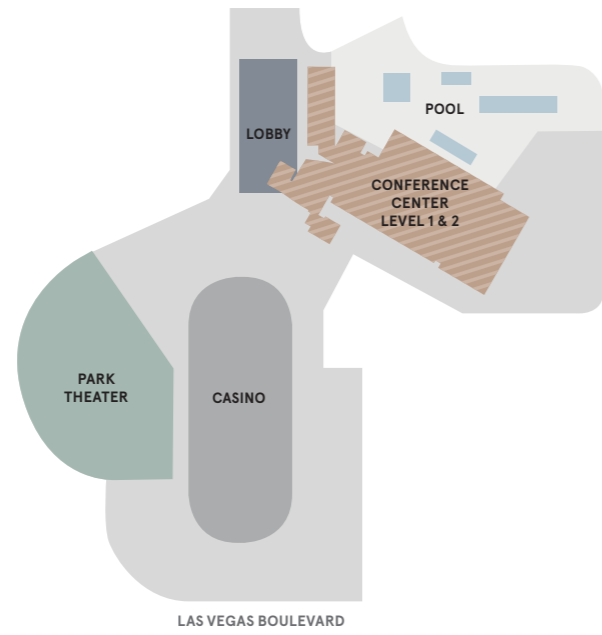

## Level 1

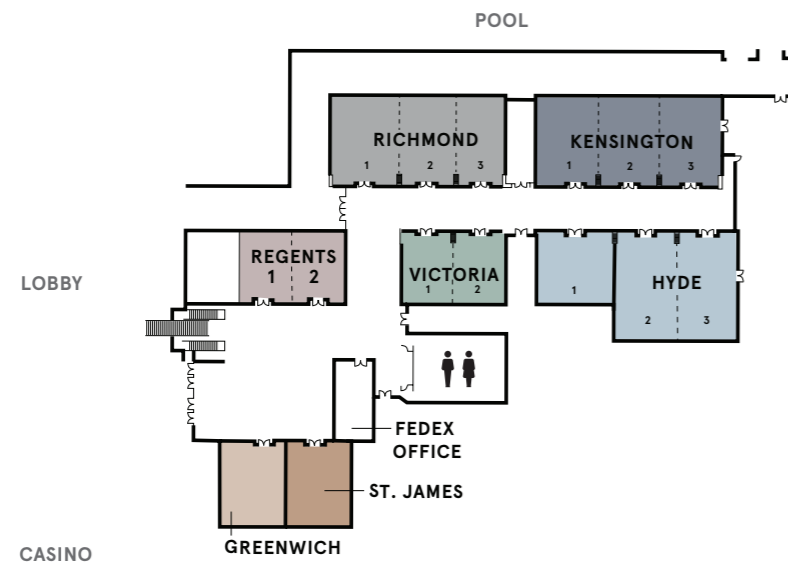

## Level 2

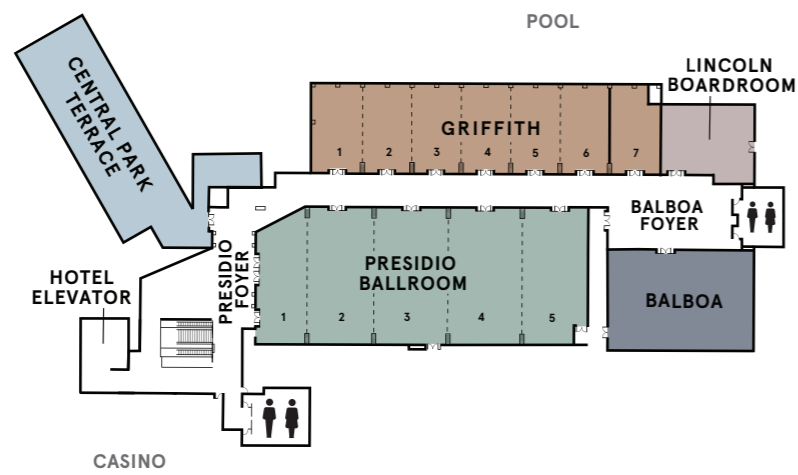

3770 S Las Vegas Blvd, Las Vegas, NV 89109

ParkMGM.com



# PARK MGM

LAS VEGAS

An MGM Resorts Luxury Destination

## FACILITIES GUIDE

# Conference Center

## Level 1

	Sq. Ft.	Dimensions	Ceiling Height	Theatre	Classroom	Banquet Rounds	Reception	Hollow Square	U-Shape	Conference	Exhibits 8x8	Exhibits 8x10"
GREENWICH	1,174	43.5' x 27'	12'	160	72	60	120	42	33	30	-	-
ST. JAMES	1,174	43.5' x 27'	12'	160	72	60	120	42	32	30	-	-
REGENTS	2,050	38' x 54'	12'	222	99	100	-	60	51	48	-	-
1	1,026	38' x 27'	12'	104	50	60	90	36	27	24	-	-
2	1,026	38' x 27'	12'	104	50	60	90	36	27	24	-	-
RICHMOND	3,806	43.5 x 87.5	12'	441	224	210	330	-	-	-	28	24
1	1,522	43.5' x 35'	12'	158	84	90	150	48	36	24	10	-
2	1,174	43.5' x 27.5'	12'	160	72	60	120	42	33	30	10	-
3	1,087	43.5 x 25'	12'	150	60	60	120	40	32	30	10	-
1-2	2,718	43.5' x 62.5'	12'	360	162	180	240	-	-	-	20	16
2-3	2,283	43.5' x 52.5'	12'	230	140	150	210	-	-	-	16	13
KENSINGTON	4,050	43.5' x 93'	12'	483	255	240	350	-	-	-	28	24
1	1,152	43.5' x 26.5'	12'	140	70	60	130	42	30	30	10	-
2	1,392	43.5' x 32'	12'	140	84	90	160	50	40	41	10	-
3	1,500	43.5' x 34.5'	12'	150	84	90	160	50	42	30	10	-
1-2	2,544	43.5' x 58.5'	12'	300	174	150	240	-	-	-	20	14
2-3	2,892	43.5 x 66.5'	12'	360	168	150	280	-	-	-	20	16
HYDE	-	-	-	-	-	-	-	-	-	-	-	-
1	1,360	34' x 40'	12'	160	80	80	180	48	39	36	8	8
2	1,530	51' x 30'	12'	164	96	80	170	48	39	36	10	10
3	1,632	51' x 32'	12'	192	96	80	170	48	45	42	10	10
2-3	3,162	51' x 62'	12'	352	216	200	340	-	-	-	20	20
VICTORIA	1,794	34.5' x 52	12'	196	110	110	170	56	48	48	14	10
1	914	34.5' x 26.5'	12'	112	53	50	80	36	30	24	-	-
2	879	34.5' x 25.5'	12'	98	45	50	80	38	30	24	-	-

# Conference Center

## Level 2

	Sq. Ft.	Dimensions	Ceiling Height	Theatre	Classroom	Banquet Rounds	Reception	Hollow Square	U-Shape	Conference	Exhibits 8x8	Exhibits 8x10"
CENTRAL PARK TERRACE	4,345	32.8' x 94.6'	-	-	-	210	350	-	-	-	-	-
PRESIDIO BALLROOM	12,888	72' x 179'	12'	1,425	756	700	950	-	52	-	84	80
1	1,330	70" x 19'	12'	119	78	80	100	60	60	56	7	8
2	2,880	72' x 40'	12'	270	182	150	250	78	60	48	22	16
3	2,880	72' x 40'	12'	270	182	150	250	78	60	48	22	16
4	2,880	72' x 40'	12'	270	182	150	250	78	60	48	22	16
5	2,880	72' x 40'	12'	270	182	150	250	78	60	48	22	16
1-2	4,248	72" x 59'	12'	384	286	250	350	-	-	-	30	21
1-3	7,128	72' x 99'	12'	720	396	390	600	-	-	-	42	35
1-4	10,080	72' x 140'	12'	1,050	583	550	800	-	-	-	55	49
2-3	5,760	72' x 80'	12'	651	300	300	500	-	-	-	30	28
2-4	10,080	72' x 140'	12'	930	484	490	690	-	-	-	45	42
2-5	11,520	72" x 160'	12'	1,260	660	640	920	-	-	-	72	56
3-4	5,760	72' x 80'	12'	644	300	300	460	-	-	-	30	28
3-5	8,640	72' x 120'	12'	924	484	450	690	-	-	-	45	42
4-5	5,760	72' x 80'	12'	637	300	300	460	-	-	-	30	28
GRIFFITH (1-6)	7,498	46' x 163'	12'	702	406	390	600	-	-	-	48	44
1	1,219	46' x 26.5'	12'	140	74	70	85	42	36	24	10	-
2	1,219	46' x 26.5'	12'	160	84	70	85	42	36	24	10	-
3	1,265	46' x 27.5'	12'	160	84	70	85	42	36	24	10	-
4	1,265	46' x 27.5'	12'	160	84	70	85	42	36	24	10	-
5	1,265	46' x 27.5'	12'	160	84	70	85	42	36	24	10	-
6	1,265	46' x 27.5'	12'	160	84	70	85	42	36	24	10	-
1-2	2,438	46" X 53'	12'	270	144	140	200	-	-	-	18	16
1-3	3,703	46' x 80.5'	12'	378	224	210	270	-	-	-	24	20
1-4	4,970	46' x 108'	12'	540	304	270	350	-	-	-	27	28
1-5	6,235	46' x 135.5'	12'	558	324	330	430	-	-	-	39	36
2-3	2,485	46' x 54'	12'	270	144	140	200	-	-	-	16	12
2-4	3,750	46' x 81.5'	12'	350	224	210	270	-	-	-	24	20
2-5	5,015	46' x 109'	12'	432	304	270	350	-	-	-	27	28
2-6	6,280	46' x 136.5'	12'	558	324	330	430	-	-	-	39	44
3-4	2,530	46' x 55'	12'	270	144	140	200	-	-	-	18	16
3-5	3,795	46' x 82.5'	12'	350	208	210	270	-	-	-	24	20
3-6	5,060	46' x 110'	12'	432	280	270	350	-	-	-	27	28
4-5	2,530	46' x 55'	12'	350	208	140	200	-	-	-	18	16
4-6	3,795	46' x 82.5'	12'	432	280	210	270	-	-	-	24	20
5-6	2,530	46' x 55'	12'	350	208	140	200	-	-	-	18	16
GRIFFITH 7	1,298	44' x 29.5'	9'	152	80	70	85	42	36	24	10	-
LINCOLN BOARDROOM	900	36' x 25'	9'	-	-	-	-	-	-	18	-	-
BALBOA	3,196	59.75' x 53.5'	12'	385	209	200	340	78	64	48	26	22